

Does the distribution box have a grounding device

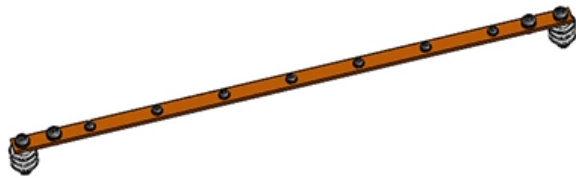



Does the distribution box have a grounding device



Grounding System Installation Standards for Distribution Boxes and

Your distribution box is mission control for electricity in any building. When grounding fails here, it's like having a spaceship without a heat shield--everything inside becomes vulnerable to surges, faults,

[Contact Us](#)

The Complete Guide to Distribution Box: Installation, Types & More

Quality distribution boxes represent a wise investment that pays dividends through improved safety, reduced maintenance costs, and enhanced system flexibility. As electrical demands

[Contact Us](#)

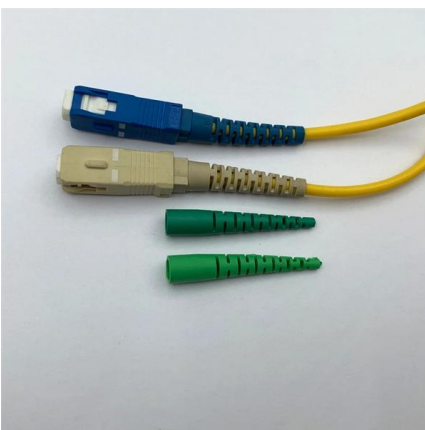

What does a power distribution box do ?

The main function of the distribution box is to receive power and distribute it to various circuits. It can protect circuits, regulate voltage, and isolate and control

[Contact Us](#)

System Grounding

This type of system is known as a pulsing ground detection system and is very effective in locating ground current trips but is generally more expensive than the ungrounded system ground current trip



What does a distribution box do?

Grounding device: to ensure the safety of circuit equipment grounding and prevent grounding faults from causing safety accidents. The

[Contact Us](#)



Grounding Practices in Power Distribution Systems

Grounding Electrodes: Grounding electrodes, which can be rods or plates, are inserted at regular intervals along the cable route in order to offer additional

[Contact Us](#)



how do you ground a plastic electrical box

Share to: In power systems, grounding is an important safety measure that protects equipment and personnel from electric shock. However, with plastic

[Contact Us](#)



Electrical Panel Grounding and Bonding



The topic of grounding and bonding is a never ending area of confusion. The difference between a service panel and a sub panel is also muddy in many

[Contact Us](#)



DISTRIBUTION BOX

Each DISTRIBUTION BOX and controller must be grounded. On the US market, a 5.26 mm² (10 AWG) ground wire must be used, and in all other markets a 6 mm² must be used.

[Contact Us](#)



What is a Distribution Box? - A Comprehensive Guide

Imagine a world where every electrical device in your home or workplace relied on a single circuit. Overloads and frequent failures would disrupt

[Contact Us](#)

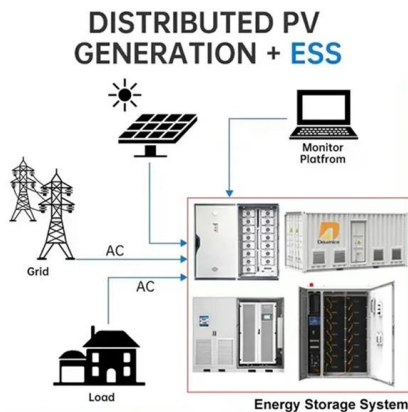

How to Install a Cable Distribution Box Safely and

Understanding Cable Distribution Boxes A cable distribution box is an electrical device used to collect, distribute, and protect electrical power. It is

[Contact Us](#)



The Importance of Protective Grounding Boxes for Safety

What is a Protective grounding box? A protective grounding box is a device that is used to protect electrical equipment and workers from electrical faults. It is designed to provide a safe path

[Contact Us](#)

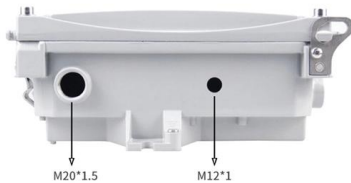

Single Phase Distribution Box Definition and Main Parts

You can trust a single phase distribution box to help your circuits work well and stay safe every day. Key Takeaways A single phase distribution box helps control and share electricity in your home or

[Contact Us](#)

What Is a Distribution Box?

In Conclusion Most residential and commercial electrical systems have at least one distribution box. A distribution box is a device that, as the name

[Contact Us](#)



Pre-Terminated Patch Panel

- Multi-application support
- Flexible configuratvion
- Modular design



Multi-functional Sliding Patch Box, Modular



Modular Sliding Patch Box



Sliding Patch Box, Modular

The Importance of Direct Grounding Box for Electrical

Direct Grounding Box provides a safe pathway for the discharge of electrical charges, protecting electrical equipment and ensuring electrical safety.

[Contact Us](#)

What Is an Electrical Distribution Box and



Why Is It

An electrical distribution box distributes power safely, prevents overloads, and protects circuits, ensuring efficient and reliable electrical systems.

[Contact Us](#)



Electrical grounding explained

Grounding applications FAQs How electrical grounding works Electrical grounding establishes an effective route for discharging electric current,

[Contact Us](#)

How to ground the low voltage distribution box?

The manufacturer of low-voltage distribution box indicates that this is called the zero connection protection system. TN-C power supply system uses the working zero

[Contact Us](#)



Does the Distribution Box Door Need Grounding? Safety Standards FAQ

Without grounding, anyone touching it becomes the path to earth--and gets shocked (or worse). NEC 250.148 doesn't play favorites: The code mandates that all metallic parts of electrical boxes must

[Contact Us](#)





Does the Distribution Box Door Need Grounding? Safety Standards FAQ

Choose a dedicated grounding screw or clip --not a reused bolt or hinge. Run a separate copper wire (usually 12 AWG) from the door to the cabinet's grounding bar.

[Contact Us](#)



Electrical Box Ground Wire Connectors & Connections

How to make proper & safe electrical ground wiring connections in the box: This article describes options for connecting a metal electrical box to the grounding conductor & connecting the grounding

[Contact Us](#)

What is the Function of a Distribution Box in Electrical Systems

The distribution box plays a crucial function in the distribution box of electrical systems. It helps electricity move safely to different circuits, ensuring that power is utilized efficiently. This box protects

[Contact Us](#)



Understanding Distribution Boxes:A Comprehensive Guide

A distribution boxes is an essential device that manages the safe and efficient flow of electrical power throughout different areas of a building or facility.

[Contact Us](#)



The Importance of Ground Wires in the Breaker Box: A

The ground wire in a breaker box is a crucial element of an electrical system, providing safety and preventing electrical shocks. Learn more about its

[Contact Us](#)



How do you ground a plastic electrical box

If there is any damage or cracks in the electrical box, you should repair it first before grounding it. In addition, you also need to check whether the

[Contact Us](#)

Grounding system construction: key points for grounding distribution

Think of it this way: That distribution box in your facility? It's not just a metal container - it's the quarterback coordinating all electrical flows. If its grounding fails, every connected device

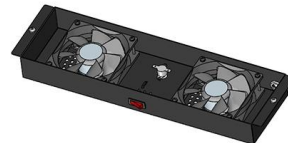

[Contact Us](#)



Understanding Distribution Boxes: A Comprehensive Guide

A distribution box, also known as a power distribution box or electrical distribution box, is used to distribute electrical power safely to multiple

[Contact Us](#)



Correct Connection Method Of Grounding Wire Of

Open the distribution box and find the position marked with the grounding plate or PE letter. This position is the connection point of the grounding

[Contact Us](#)

LED DISPLAY PANEL

CURRENT STATUS CLEARLY VISIBLE

IT CAN CLEARLY SHOW THE CURRENT STATUS AND VOLTAGE STATUS,
WITH EFFICIENT OPERATION AND RAPID RESPONSE.

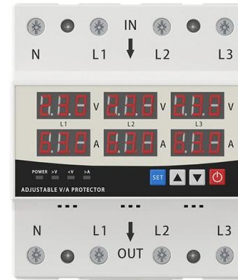

Contact Us

For datasheets, pricing, or custom fiber access solutions, please visit:
<https://www.frindel.es>